

## Property Online Map

Date: August 13, 2024 14:20:26

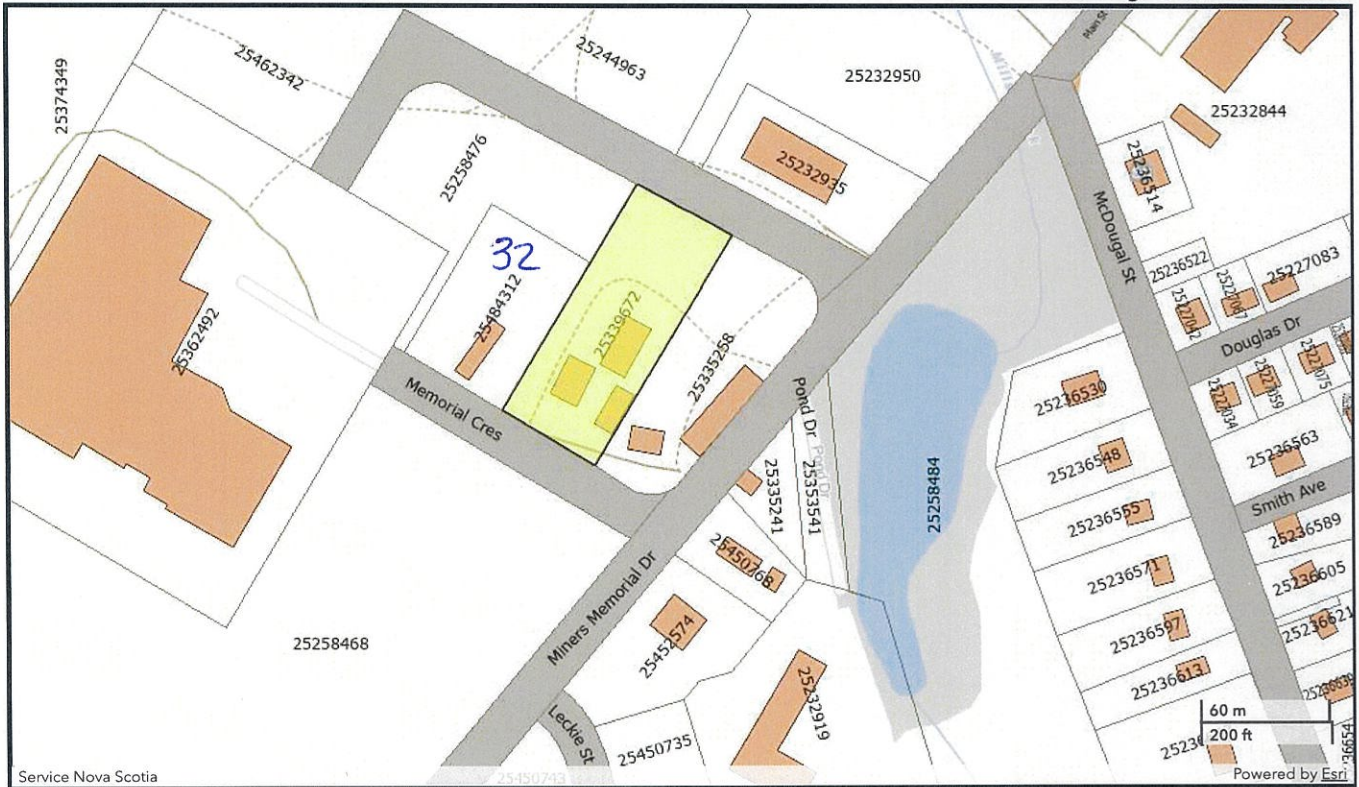

<b>PID:</b>	25339672	<b>Address:</b>	36 MEMORIAL CRESCENT SPRINGHILL LOT 8B	<b>AAN:</b>	07483023
<b>County:</b>	CUMBERLAND COUNTY	<b>Owner:</b>	D R MARTINS METAL WORKS LTD	<b>Value:</b>	\$217,300.00 (2024 COMMERCIAL TAXABLE)
<b>LR:</b>	NOT LAND REGISTRATION				

The Provincial mapping is a graphical representation of property boundaries which approximate the size, configuration and location of parcels. Care has been taken to ensure the best possible quality, however, this map is not a land survey and is not intended to be used for legal descriptions or to calculate exact dimensions or area. The Provincial mapping is not conclusive as to the location, boundaries or extent of a parcel [Land Registration Act subsection 21(2)]. THIS IS NOT AN OFFICIAL RECORD.

### Property Online Version 1.0

This page and all contents are copyright © 1999-2024, [Government of Nova Scotia](http://Government of Nova Scotia), all rights reserved.  
If you have comments regarding our site please direct them to: [propertyonline@novascotia.ca](mailto:propertyonline@novascotia.ca)  
Please feel free to [Submit Problems](#) you find with the Property Online web site.

07483023 36 MEMORIAL CRES SPRINGHILL



© All EagleView Technology Corporation

04/23/2023

TAX ACCOUNT#: 7483023

PROPERTY: Lot 88, 36 Memorial Crescent, Springhill, Nova Scotia

ASSESSED TO: D R Martins Metal Works Ltd.

APPARENT PID: 25339672

---

ALL and singular that certain lot of land situate on the south side of Memorial Crescent (not developed) in the Springhill Industrial Park, Springhill, Cumberland County, Province of Nova Scotia and being shown as Parcel A on a plan of subdivision creating Parcel A lands of Nova Scotia Business Incorporated to be consolidated with lands of D.R. Martin's Metal Works Limited to create Lot 8B prepared by Jerry L. Borden, N.S.L.S dated the 16<sup>th</sup> day of February, A.D. 2006 and being more particularly described as follows:

[Directions in the following are oriented to the Nova Scotia C-ordinate Grid 3 def. MTM Zone 5 Central Meridian 64 deg. 30 min. West Longitude]

BEGINNING at a survey marker on the southerly boundary of Memorial Crescent, said survey marker also being the northwesterly corner of Lot 14, lands of the Town of Springhill;

THENCE S 29 deg. 46 min. 06 sec. W a distance of 50.341 metres along the northwesterly boundary of Lot 14 to the northeasterly corner of Lot 8A, lands of D. R. Martin's Metal Works Limited;

THENCE N 60 deg. 13 min. 54 sec. W a distance of 48.768 metres along the northerly boundary of Lot 8A to the northwesterly corner thereof;

THENCE N 29 deg. 46 min. 06 sec. E a distance of 48.193 metres along remaining lands of Nova Scotia Business Incorporated to a survey marker on the southerly boundary of Memorial Crescent;

THENCE S 62 deg. 45 min. 14 sec. E a distance of 48.815 metres along the southerly boundary of Memorial Crescent to the place of beginning.

SAID DESCRIBED LOT to contain 2402.6 square metres.

BEING AND INTENDED TO BE a portion of those lands described in a deed to Nova Scotia Business Incorporated being recorded in the Cumberland Land Registry in Book 753 at Page 286.

MUNICIPALITY OF THE  
 COUNTY OF  
 CUMBERLAND  
 JUR: 47  
 AAN: 07483023

Primary Assignment: 47 - Allan Byers  
 Secondary Assignment: 47 - Allan Byers

**NBHD: 510941 LUC: 0707 Res/Com: C ROLLTYPE: RPPROLLYEAR: 2024**  
 D R MARTINS METAL WORKS LTD  
 36 MEMORIAL CRES SPRINGHILL

Land Size 1.46 Acres

**Values History**

Year	Land	Building	OBV	Total Building	Total Market Value Assessment	Cap Assessment
2024	\$10,200	\$166,300	40800	\$207,100	\$217,300	\$0
2023	\$10,200	\$146,000	37500	\$183,500	\$193,700	\$0
2022	\$10,200	\$131,100	35400	\$166,500	\$176,700	\$0
2021	\$10,200	\$130,200	34200	\$164,400	\$174,600	\$0
2020	\$9,900	\$132,800	35000	\$167,800	\$177,700	\$0
2019	\$9,900	\$170,200	21400	\$191,600	\$201,500	\$0
2018	\$9,900	\$168,700	21200	\$189,900	\$199,800	\$0
2017	\$9,900	\$168,900	20900	\$189,800	\$199,700	\$0
2016	\$9,900	\$181,500	21200	\$202,700	\$212,600	\$0
2015	\$9,900	\$180,700	19200	\$199,900	\$209,800	\$0
2014	\$9,900	\$172,200	17800	\$190,000	\$199,900	\$0
2013	\$9,900	\$172,000	17300	\$189,300	\$199,200	\$0
2012	\$9,900	\$165,400	16100	\$181,500	\$191,400	\$0
2011	\$9,900	\$159,000	15700	\$174,700	\$184,600	\$0
2010	\$9,900	\$158,400	12300	\$170,700	\$180,600	\$0
2009	\$9,900	\$157,100	12300	\$169,400	\$179,300	\$0
2008	\$6,800	\$138,200	12100	\$150,300	\$157,100	\$0

**MH Data**

MH Width:  
 MH Length:  
 MH Make:  
 MH Model:  
 MH Park Name:  
 MH Serial #: