

01480952 1423 MURRAY RD, PUGWASH A GRAPHICAL REPRESENTATION ONLY

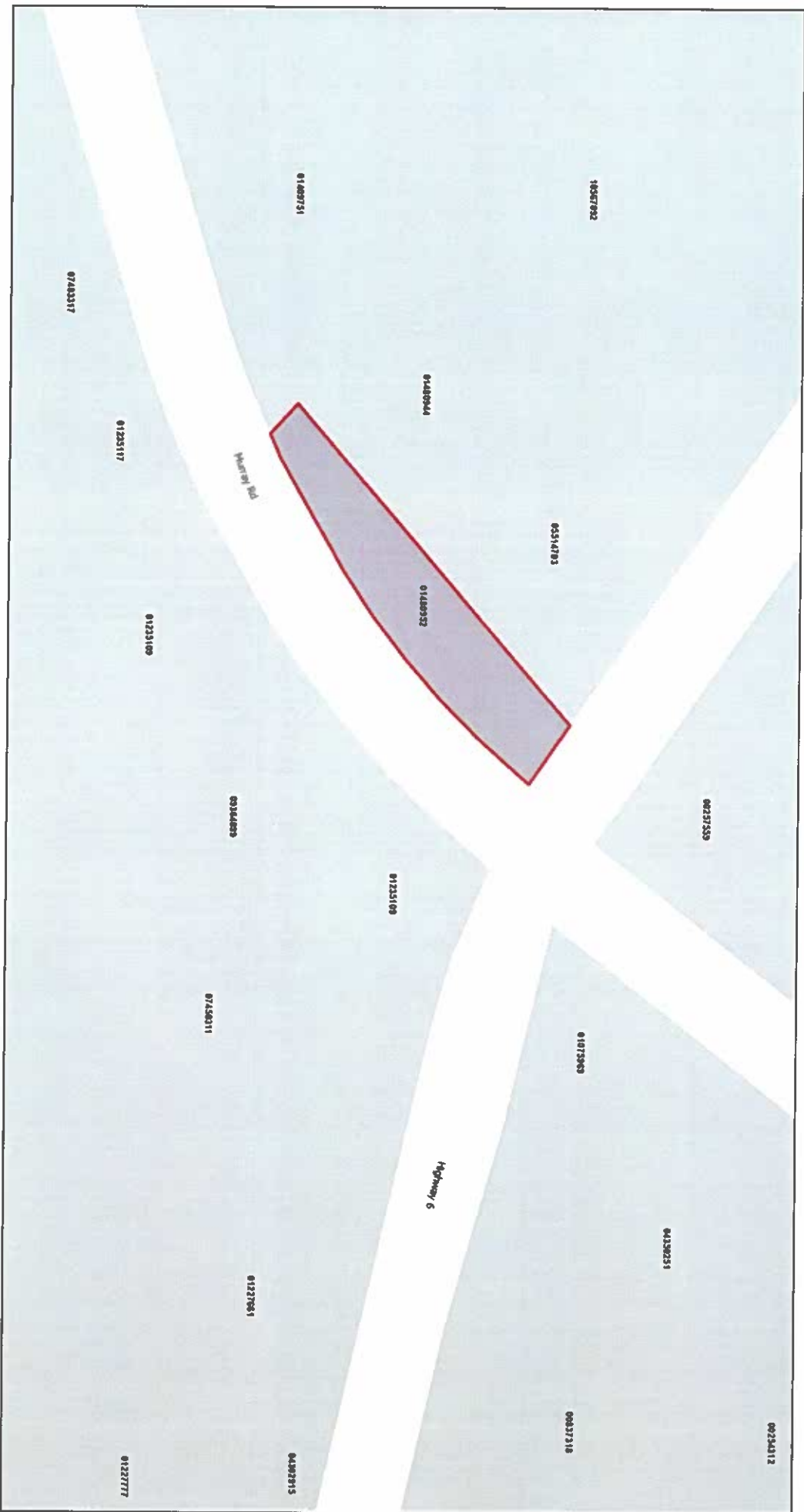

January 17, 2025

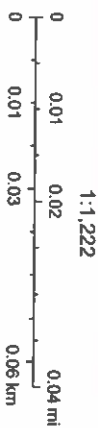

**01480952 - 1423 MURRAY RD, PUGWASH - A GRAPHICAL REPRESENTATION ONLY**



© All EagleView Technology Corporation

04/28/2023

MUNICIPALITY OF THE

JUR: 47

COUNTY OF

AAN: 01480952

CUMBERLAND

Primary Assignment: 47 - Allan Byers

Secondary Assignment: 47 - Allan Byers

**NBHD: 470355 LUC: 0000**

**Res/Com: R**

**ROLLTYPE: RPROLLEYEAR: 2026**

**CANNING FREEMAN R & GERTRUDE**

**1423 MURRAY RD PUGWASH**

1 of 10

Land Size 25,109.00 Sq. Ft.

### Values History

Year	Land	Building	OBY	Total Building	Total Market Value Assessment	Cap Assessment
2025	\$21,900	\$110,900	20100	\$131,000	\$152,900	\$83,100
2024	\$20,200	\$92,100	16300	\$108,400	\$128,600	\$81,900
2023	\$16,500	\$66,300	12900	\$79,200	\$95,700	\$79,400
2022	\$13,000	\$57,100	12200	\$69,300	\$82,300	\$73,800
2021	\$12,000	\$51,100	12400	\$63,500	\$75,500	\$70,100
2020	\$12,000	\$51,000	12500	\$63,500	\$75,500	\$69,900
2019	\$13,000	\$54,300	12300	\$66,600	\$79,600	\$69,300
2018	\$13,000	\$55,000	12300	\$67,300	\$80,300	\$67,400
2017	\$13,000	\$55,600	12300	\$67,900	\$80,900	\$66,800
2016	\$13,000	\$56,700	12300	\$69,000	\$82,000	\$65,900
2015	\$13,000	\$60,900	11900	\$72,800	\$85,800	\$65,800
2014	\$13,000	\$61,800	12900	\$74,700	\$87,700	\$64,500
2013	\$12,300	\$60,600	12900	\$73,500	\$85,800	\$64,000
2012	\$12,300	\$59,700	3600	\$63,300	\$75,600	\$62,300
2011	\$12,000	\$62,400	3700	\$66,100	\$78,100	\$60,000
2010	\$9,200	\$65,600	2900	\$68,500	\$77,700	\$58,400
2009	\$8,400	\$60,400	2600	\$63,000	\$71,400	\$58,400
2008	\$7,500	\$53,400	2300	\$55,700	\$63,200	\$56,600

### MH Data

MH Width:  
 MH Length:  
 MH Make:  
 MH Model:  
 MH Park Name:  
 MH Serial #:

ALL that lot of land situate at West Pugwash, in the County of Cumberland, and Province of Nova Scotia, more particularly bounded and described as follows:-

BEGINNING at a set iron bar at the intersection of the Westerly margin of the Sunrise Trail, so-called, being Provincial Highway # 6, with the Northerly margin of the Murray Road, so-called;

THENCE North Thirty-three Degrees Thirty-four Minutes West (N33°34'W) along the Sunrise Trail a distance of Fifty point Forty-five Feet (50.45') to a found iron pin;

THENCE South Seventy-two Degrees Twenty-six Minutes West (S72°26'W) a distance of Two Hundred and Ninety-seven point Fifteen Feet (297.15') to a set iron bar;

THENCE South Twenty-three Degrees Fifteen Minutes East (S23°15'E) a distance of Thirty-three point Seventy-one Feet (33.71') to a set iron bar on the Northerly margin of the aforesaid Murray Road;

THENCE along the Northerly margin of the said Murray Road a distance of Three Hundred and Ten Feet (310'), more or less, in an arc having a tie line running South Seventy-five Degrees Twelve point Seven Minutes East (S75°12.7'E) a distance of Three Hundred and Eight point Zero Six Feet (308.06') to the place of beginning.

CONTAINING Fifteen Thousand Five Hundred (15,500) Square Feet, more or less.

BEING those lands conveyed by the heirs-at-law of Greta White to Margaret Ferdinand by Deed dated the 5th day of November, A.D., 1973 and recorded at the Registry of Deeds Office, Amherst, N.S., in Book 311 at Page 519 and as shown on a Plan entitled "Plan Showing Lands of James Ferdinand" drawn by Daniel B. Burke dated the 19th day of October, A.D., 1977 and filed at the Registry aforesaid as P-No. 1137.

BEING that land conveyed to Central Mortgage and Housing Corporation by Margaret Ferdinand by Deed dated the 20th day of September, A.D., 1978 and recorded at the said Registry in Book 374, at Page 89.

AND BEING that land conveyed to James Ferdinand and Margaret Ferdinand by Central Mortgage and Housing Corporation by Deed dated the 10th day of April, A.D., 1979 and recorded at the Registry of Deeds aforesaid in Book 378, at Page 733.

AND ALSO BEING the same lands as conveyed by Sheriff's Deed dated the 26th day of November, 1984 to Canada Mortgage and Housing Corporation and recorded at the Registry of Deeds aforesaid in Book 462, at Page 86.

AND ALSO BEING the same lands as conveyed by Quit Claim Deed from Ella Ferdinand, Verna Bergman, Cora Reid, Ronald White, Arnold White, Myra Bonnyman, Jackeline White and Robert White dated April 3rd, 1986 to Canada Mortgage and Housing Corporation and recorded at the Registry of Deeds aforesaid in Book 498, at Page 875.

AND ALSO BEING AND INTENDED TO BE the same lands as conveyed from Aubrey M. Chapman to Canada Mortgage and Housing Corporation by sheriff's deed dated the 3rd day of January, 1989 and recorded in the Registry of Deeds at Amherst in the County of Cumberland, N.S., on January 3rd, 1989 in Book Number 527 at Pages 36 - 37.

Legal Description  
Approved by

OCT 10 1989

CMHC