

04461223 131 HERRETT RD, SPRINGHILL A GRAPHICAL REPRESENTATION ONLY

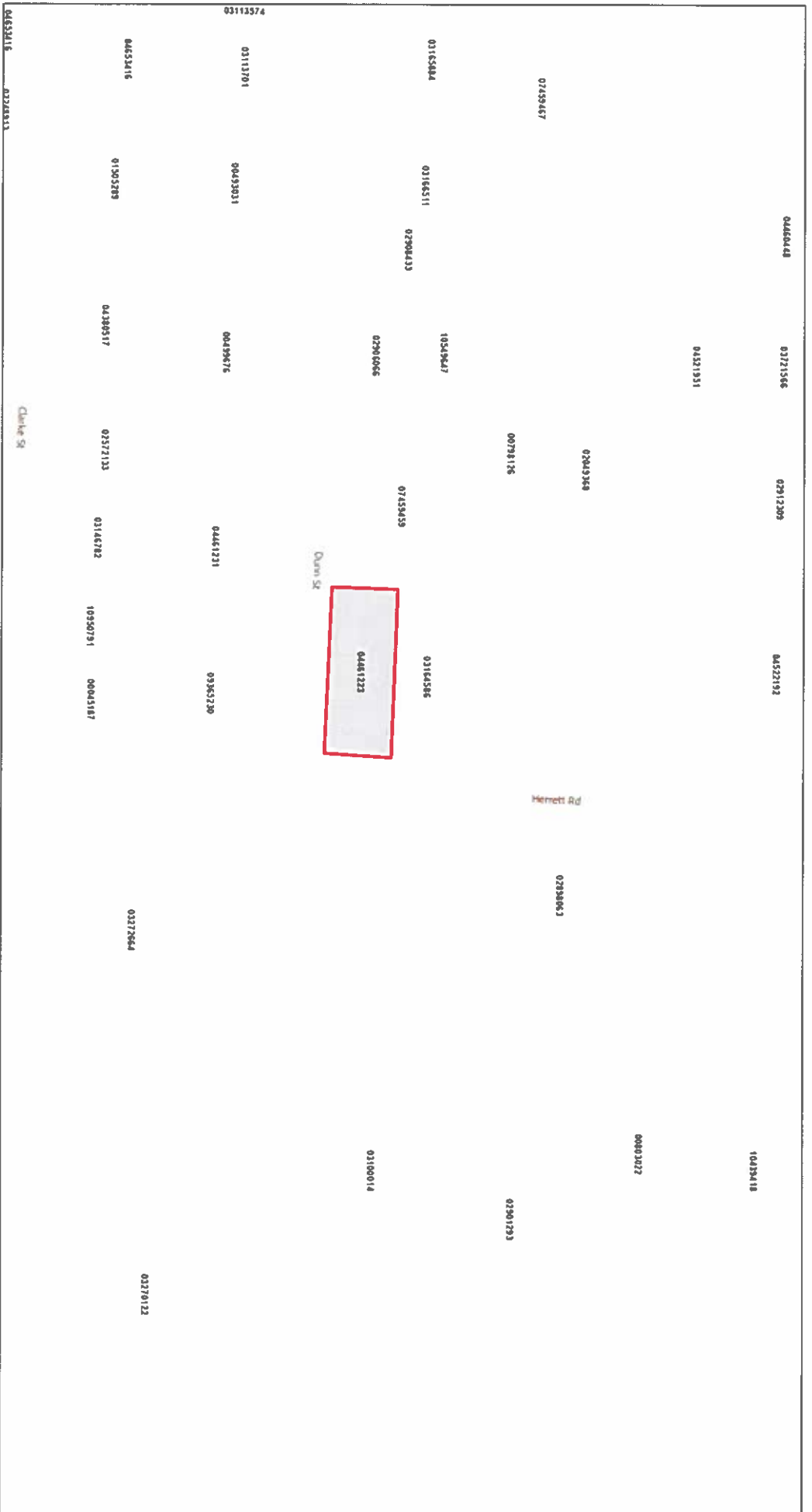

February 5, 2025

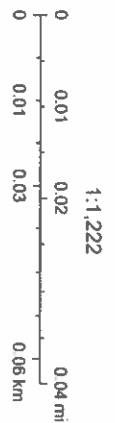

04461223 - 131 HERRETT RD, SPRINGHILL - A GRAPHICAL REPRESENTATION ONLY



© All EagleView Technology Corporation

04/23/2023

MUNICIPALITY OF THE
 COUNTY OF
 CUMBERLAND

JUR: 47

AAN: 04461223

Primary Assignment: 47 - Allan Byers
 Secondary Assignment: 47 - Allan Byers
NBHD: 510107 LUC: 0000 Res/Com: R ROLLTYPE: RPPROLLYEAR: 2025
 COOKE MARILYN CHRISTINE
 131 HERRETT RD SPRINGHILL

Land Size 6,073.00 Sq. Ft.

Values History

Year	Land	Building	OBV	Total Building	Total Market Value Assessment	Cap Assessment
2024	\$11,000	\$0	0	\$0	\$11,000	\$6,700
2023	\$6,500	\$0	0	\$0	\$6,500	\$0
2022	\$6,500	\$0	0	\$0	\$6,500	\$0
2021	\$6,500	\$0	0	\$0	\$6,500	\$0
2020	\$6,500	\$0	0	\$0	\$6,500	\$0
2019	\$6,500	\$27,800	0	\$27,800	\$34,300	\$0
2018	\$6,500	\$28,000	0	\$28,000	\$34,500	\$0
2017	\$6,500	\$28,500	0	\$28,500	\$35,000	\$0
2016	\$7,000	\$28,500	0	\$28,500	\$35,500	\$0
2015	\$8,000	\$28,800	0	\$28,800	\$36,800	\$35,700
2014	\$8,000	\$28,700	0	\$28,700	\$36,700	\$35,000
2013	\$8,000	\$28,600	0	\$28,600	\$36,600	\$34,700
2012	\$8,000	\$29,300	0	\$29,300	\$37,300	\$34,300
2011	\$8,000	\$28,300	0	\$28,300	\$36,300	\$33,100
2010	\$6,000	\$26,600	0	\$26,600	\$32,600	\$32,200
2009	\$6,000	\$26,200	0	\$26,200	\$32,200	\$0
2008	\$6,000	\$25,600	0	\$25,600	\$31,600	\$0

MH Data

MH Width:
 MH Length:
 MH Make:
 MH Model:
 MH Park Name:
 MH Serial #:

PID 25230210

Parcel Description

ALL that lot of land which was conveyed to the Grantor by Willena McLeod by Deed bearing date the 1st day of November, A.D., 1923, and recorded at the Office of the Registrar of Deeds for the County of Cumberland at Amherst in Book 156 at Page 35-37 and which is therein described as follows:

ALL that certain lot of land situate in the Town of Springhill on the Northwest corner of Dunn Street and Herrett Road, having a frontage on the said Herrett Road of 49 Feet and running back Westerly preserving a uniform width a distance of 125.5 Feet

BEING bounded on the North by lands now owned by the said Samuel McLeod;

ON the West by lands of the said Willena McLeod;

On the south by said Dunn Street; and

ON the east by said Herrett Road.

BEING that same of land conveyed by Phyllis Stonehouse and Alice Margaret Mitchell by Deed dated the 28th day of September, A.D., 2001 said Deed recorded at the Registry of Deeds Office at Amherst, Nova Scotia in Book 749 at Page 64.

_____ The parcel was created by a subdivision that predates subdivision control or planning legislation or by-laws in the municipality and therefore no subdivision approval was required for creation of this parcel;