

07425333 ROCKLEY A GRAPHICAL REPRESENTATION ONLY

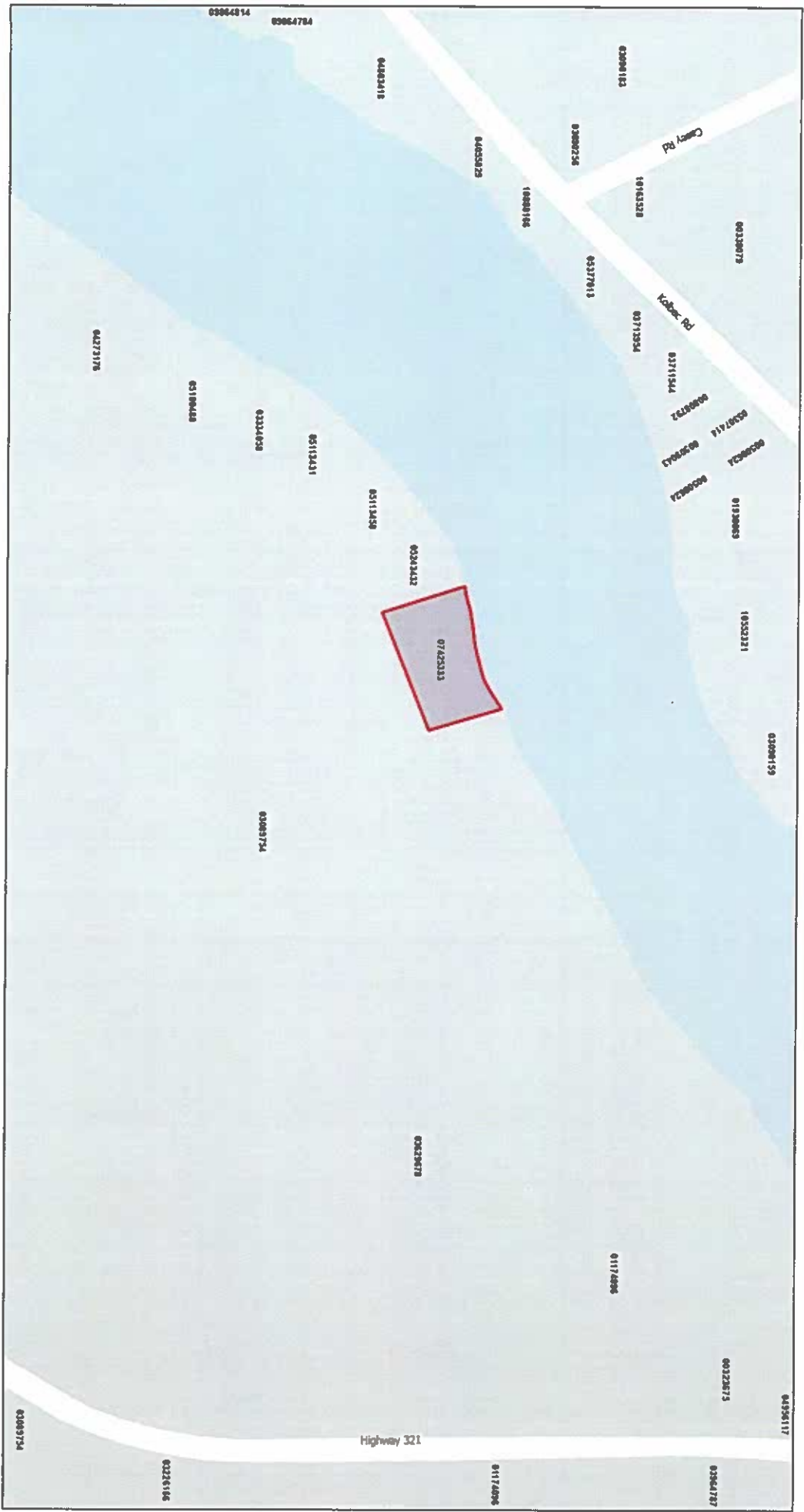

January 17, 2025

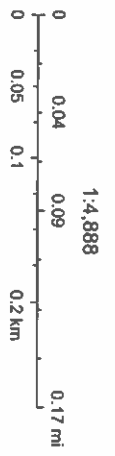

07425333 - ROCKLEY - A GRAPHICAL REPRESENTATION ONLY



04/30/2020



MUNICIPALITY OF THE

JUR: 47

COUNTY OF

AAN: 07425333

CUMBERLAND

Primary Assignment: 47 - Allan Byers

Secondary Assignment: 47 - Allan Byers

NBHD: 470352 LUC: 0000 Res/Com: R ROLLTYPE: RPROLLEYEAR: 2026

PSAILA MARIA CARMENA ISABEL

ROCKLEY

1 of 10

Land Size .00 Acres

Sales

Price	Date	Number of Parcels
\$0	30-JUL-2021	1

Values History

Year	Land	Building	OBY	Total Building	Total Market Value Assessment	Cap Assessment
2025	\$30,000	\$0	0	\$0	\$30,000	\$10,200
2024	\$18,500	\$0	0	\$0	\$18,500	\$10,100
2023	\$15,000	\$0	0	\$0	\$15,000	\$9,800
2022	\$12,500	\$0	0	\$0	\$12,500	\$9,100
2021	\$12,500	\$0	0	\$0	\$12,500	\$8,700
2020	\$12,500	\$0	0	\$0	\$12,500	\$8,700
2019	\$12,500	\$0	0	\$0	\$12,500	\$8,700
2018	\$12,500	\$0	0	\$0	\$12,500	\$8,500
2017	\$12,500	\$0	0	\$0	\$12,500	\$8,500
2016	\$15,000	\$0	0	\$0	\$15,000	\$8,400
.015	\$15,000	\$0	0	\$0	\$15,000	\$8,400
2014	\$15,000	\$0	0	\$0	\$15,000	\$8,300
2013	\$15,000	\$0	0	\$0	\$15,000	\$8,300
2012	\$15,000	\$0	0	\$0	\$15,000	\$8,200
2011	\$9,200	\$0	0	\$0	\$9,200	\$7,900
2010	\$9,200	\$0	0	\$0	\$9,200	\$7,700
2009	\$8,400	\$0	0	\$0	\$8,400	\$7,700
2008	\$7,500	\$0	0	\$0	\$7,500	\$0

MH Data

MH Width:
 MH Length:
 MH Make:
 MH Model:
 MH Park Name:
 MH Serial #:

SCHEDULE "A"

ALL that certain lot of land situate at Rockley, Cumberland County, Nova Scotia, being shown as Lot 92-1 on a Subdivision Plan of Lands of K. Adair Mattinson et al by Grant MacDonald, N.S.L.S., dated November 8, 1992, and being more particularly bounded and described as follows:

BEGINNING at a survey marker on the northerly margin of a private right of way at the southeast corner of lands of Catherine A. Burke (Book 410, Page 57), being $315^{\circ} 13' 08''$ a distance of 2519.72 feet from N.S.C.M. #13449;

THENCE $334^{\circ} 53' 09''$ a distance of 202.50 feet along the easterly boundary of lands of Catherine A. Burke to a survey marker at the ordinary high water mark of River Philip;

THENCE northeasterly following the ordinary high water mark of River Philip a distance of 390 feet more or less to the point;

THENCE $157^{\circ} 03' 08''$ a distance of 17 feet more or less to a survey marker, being $67^{\circ} 42' 15''$ a distance of 388.07 feet from the last mentioned survey marker;

THENCE continuing $157^{\circ} 03' 08''$ a distance of 197.96 feet to a survey marker;

THENCE $247^{\circ} 03' 19''$ a distance of 380.39 feet to the place of beginning.

CONTAINING 82,600 square feet.

ALL Azimuths based on the Nova Scotia 3° Modified Transverse Mercator Projection, Zone 5, Central Meridian $64^{\circ} 30'$ West Longitude.

TOGETHER with a right of way, in common with others. 50 Feet in width to and from Provincial Highway 321 to the lands above described over the existing right of way as shown on the Plan of Subdivision creating the lands.

BEING a portion of those lands conveyed to the Grantors by Donna Mattinson by Deed dated February 26, 1991 which is recorded in the Registry of Deeds Office for Cumberland County at Amherst, Nova Scotia in Book 587 at Page 947.