

07461119 NO 2 HWY, LOWER FIVE ISLANDS A GRAPHICAL REPRESENTATION ONLY

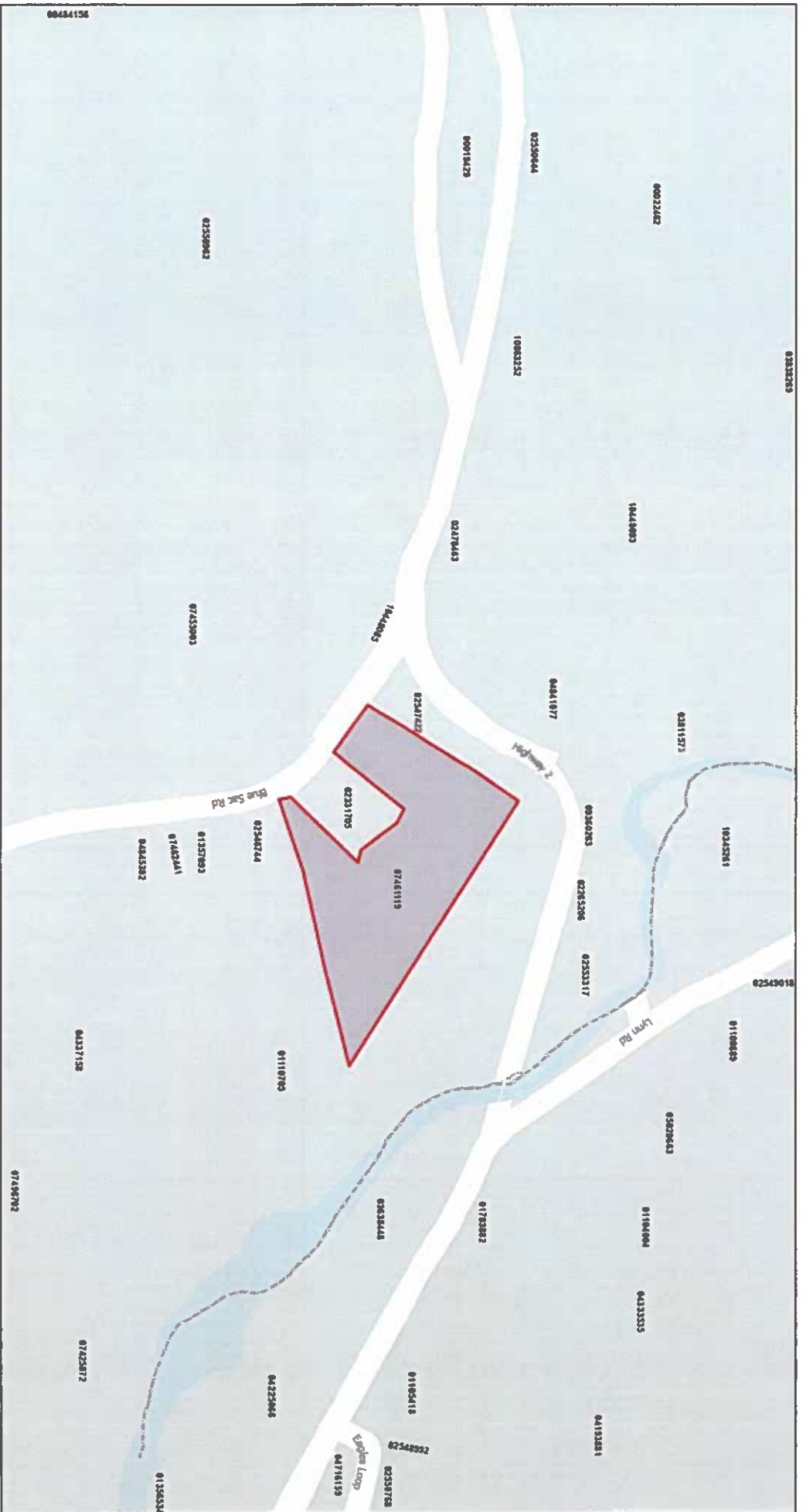

January 17, 2025

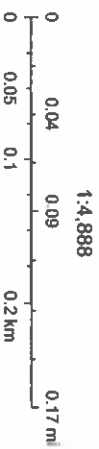

07461119 - NO 2 HWY, LOWER FIVE ISLANDS - A GRAPHICAL REPRESENTATION ONLY



MUNICIPALITY OF THE
 COUNTY OF
 CUMBERLAND
 AAN: 07461119

JUR: 47
 Primary Assignment: 47 - Allan Byers
 Secondary Assignment: 47 - Allan Byers

NBHD: 470403 LUC: 0000 Res/Com: R ROLLTYPE: RPPROLLYEAR: 2026
 WHITE THERESA M NO 2 HWY LOWER FIVE ISLANDS

Land Size 8.00 Acres

Values History

Year	Land	Building	OBY	Total Building	Total Market Value Assessment	Cap Assessment
2025	\$16,300	\$0	0	\$0	\$16,300	\$7,800
2024	\$11,300	\$0	0	\$0	\$11,300	\$7,700
2023	\$11,200	\$0	0	\$0	\$11,200	\$7,500
2022	\$9,200	\$0	0	\$0	\$9,200	\$7,000
2021	\$9,200	\$0	0	\$0	\$9,200	\$6,700
2020	\$9,200	\$0	0	\$0	\$9,200	\$6,700
2019	\$9,200	\$0	0	\$0	\$9,200	\$6,700
2018	\$9,200	\$0	0	\$0	\$9,200	\$6,600
2017	\$9,200	\$0	0	\$0	\$9,200	\$6,600
2016	\$9,200	\$0	0	\$0	\$9,200	\$6,600
2015	\$9,200	\$0	0	\$0	\$9,200	\$6,600
2014	\$9,200	\$0	0	\$0	\$9,200	\$6,500
2013	\$7,200	\$0	0	\$0	\$7,200	\$6,500
2012	\$7,200	\$0	0	\$0	\$7,200	\$6,500
2011	\$7,200	\$0	0	\$0	\$7,200	\$6,300
2010	\$7,200	\$0	0	\$0	\$7,200	\$6,200
2009	\$6,700	\$0	0	\$0	\$6,700	\$6,200
2008	\$6,000	\$0	0	\$0	\$6,000	\$0

MH Data

MH Width:
 MH Length:
 MH Make:
 MH Model:
 MH Park Name:
 MH Serial #:

MUNICIPALITY OF THE

JUR: 47

COUNTY OF

AAN: 07461119

CUMBERLAND

Primary Assignment: 47 - Allan Byers

Secondary Assignment: 47 - Allan Byers

NBHD: 470403 LUC: 0000 Res/Com: R ROLLTYPE: RPROLLEYEAR: 2026

WHITE THERESA M

NO 2 HWY LOWER FIVE ISLANDS

Land Size 8.00 Acres

Values History

Year	Land	Building	OBY	Total Building	Total Market Value Assessment	Cap Assessment
2025	\$16,300	\$0	0	\$0	\$16,300	\$7,800
2024	\$11,300	\$0	0	\$0	\$11,300	\$7,700
2023	\$11,200	\$0	0	\$0	\$11,200	\$7,500
2022	\$9,200	\$0	0	\$0	\$9,200	\$7,000
2021	\$9,200	\$0	0	\$0	\$9,200	\$6,700
2020	\$9,200	\$0	0	\$0	\$9,200	\$6,700
2019	\$9,200	\$0	0	\$0	\$9,200	\$6,700
2018	\$9,200	\$0	0	\$0	\$9,200	\$6,600
2017	\$9,200	\$0	0	\$0	\$9,200	\$6,600
2016	\$9,200	\$0	0	\$0	\$9,200	\$6,600
2015	\$9,200	\$0	0	\$0	\$9,200	\$6,600
2014	\$9,200	\$0	0	\$0	\$9,200	\$6,500
2013	\$7,200	\$0	0	\$0	\$7,200	\$6,500
2012	\$7,200	\$0	0	\$0	\$7,200	\$6,500
2011	\$7,200	\$0	0	\$0	\$7,200	\$6,300
2010	\$7,200	\$0	0	\$0	\$7,200	\$6,200
2009	\$6,700	\$0	0	\$0	\$6,700	\$6,200
2008	\$6,000	\$0	0	\$0	\$6,000	\$0

MH Data

MH Width:
 MH Length:
 MH Make:
 MH Model:
 MH Park Name:
 MH Serial #: